

●其中( )数字系小齿轮轴电机的数值。 ●The value in the ( ) is the value of small gear shaft motor.

电机特性表 List of Motor Characteristics

电机型号 Model of Motor		出力 Output	电压 Voltage	频率 Frequency	极数 Poles	额定时间 Duty	额定Rated				起动转矩 Starting Torque		电容量/耐压 Capacitor/Ve
光电机 Motor	带齿轴电机 Motor with gear shaft	W	V	Hz	P		转速Speed	电流Current	力矩Torque		N.m	kgf.cm	μF/VAC
							r/min	A	N.m	kgf.cm			
4RK25A-A	4RK25GN-A	25	1ph110	50	4	30Min	1350	0.42	0.18	1.80	0.17	1.65	6.0/500
4RK25A-C	4RK25GN-C	25	1ph220	50	4	30Min	1350	0.28	0.18	1.80	0.20	2.00	2.0/500

●使用电压不同，电容量也不相同。故应与使用电压相对应，正确使用。 ●不能正确使用是造成故障的主要原因。订货时，在确认使用电压后，选择正确的型号进行订货。  
●The capacitor capacitance will be different under different voltage. A correct capacitor capacitance is required to match the applied voltage. ●Wrong capacitor capacitance is the cause of trouble. You must confirm a correct voltage and select a correct model when your purchase order is placed.

齿轮箱外形尺寸 Overall Dimension of Gearbox

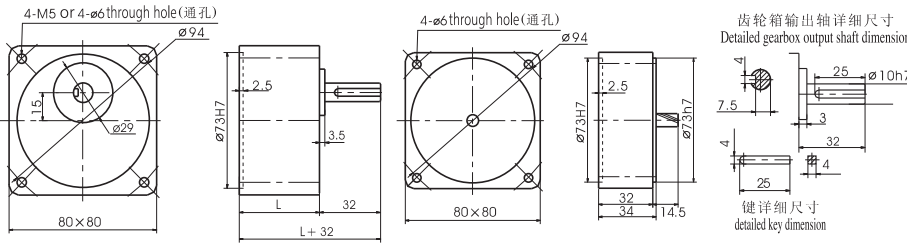

	速比Reduction Ratio	尺寸L(mm)	质量(kg)
齿轮箱 Gearbox	4GN3K-GN20K	43	0.43
	4GN25K-GN50K	45.5	0.57
	4GN60K-GN200K		0.61
中间齿轮箱 Intermediate Gearbox	4GN10X	32	0.43
电机Motor			1.58

齿轮箱允许力矩 Allowable Torque on Gearbox

齿轮箱型式 Model of Gearbox: 4GN□K

频率Frequency	减速比Reduction Ratio	3	3.6	5	6	7.5	9	10	12.5	15	18	20	25	30	36	40	50	60	75	90	100	120	150	
50Hz	输出轴转速 Output Shaft Speed	r/min	500	417	300	250	200	166	150	120	100	83	75	60	50	41	37	30	25	20	16	15	12	10
	允许力矩 Allowable Torque	N.m	0.42	0.52	0.72	0.86	1.07	1.29	1.43	1.79	2.15	2.58	2.87	3.22	3.87	4.65	5.16	6.45	7.00	7.84	7.84	7.84	7.84	7.84
60Hz	输出轴转速 Output Shaft Speed	r/min	600	500	360	300	240	200	180	144	120	100	90	72	60	50	45	36	30	24	20	18	15	12
	允许力矩 Allowable Torque	N.m	0.35	0.42	0.59	0.70	0.88	1.05	1.17	1.46	1.76	2.11	2.34	2.64	3.17	3.80	4.22	5.28	5.73	7.16	7.84	7.84	7.84	7.84
		kgf.cm	3.59	4.30	5.98	7.20	8.97	10.8	12.0	14.9	17.9	21.5	23.9	26.9	32.3	38.8	43.1	53.9	58.8	73.1	80.0	80.0	80.0	80.0

电容器 Capacitor

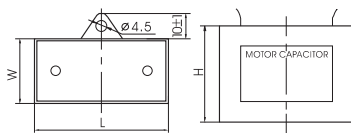

电容量 μF capacity μF	耐压 Voltage	长 L±1	宽 W±1	高 H±1	类型 Type
允许偏差±5% Allowable Deviation±5%	V	mm	mm	mm	引线式 Down-lead
2.0	500	38	15	28	
6.0	500	47	23	36	

接线图 Wiring Diagram

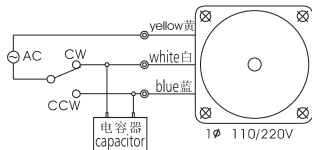

齿轮箱型式 Model of Gearbox: 4GN□K

频率Frequency	减速比Reduction Ratio	180	200	250	
50Hz	输出轴转速 Output Shaft Speed	r/min	8	7.5	6
	允许力矩 Allowable Torque	N.m	7.84	7.84	7.84
60Hz	输出轴转速 Output Shaft Speed	r/min	10	9	7.2
	允许力矩 Allowable Torque	N.m	7.80	7.80	7.80
		kgf.cm	80.0	80.0	80.0