

# 518JSX80-4468

## DC Worm Gear Motor

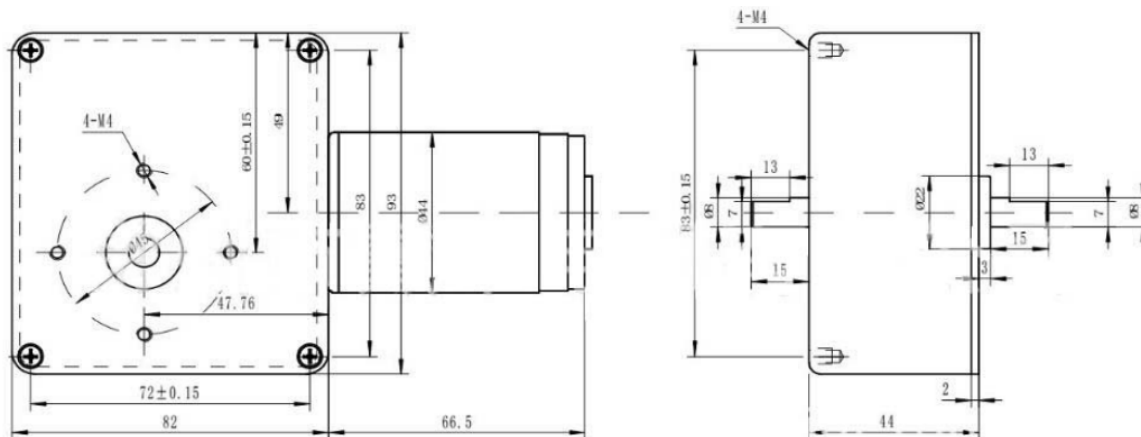

### Dimension(mm)



### Specifications

Model	Gear box								Motor	
	Reduction ratio	Rated torque (kgf.cm)	Stall torque (kgf.cm)	No-load speed (rpm)	Rated speed (rpm)	No-load current (mA)	Rated current (mA)	Stall current (mA)	Rated voltage (V)	no-load speed (rpm)
518JSX50-4468	1:50	40	/	105/103	/	400	2840/2760	8000/7900	24	5000
518JSX80-4468	1:80	20	58.5	44.5	/	400	2250/2250	8200/8200	12	3500
518JSX80-4468	1:80	60	/	45	/	150	2500/2500	3700/3600	24	3500
518JSX80-4468	1:80	50	/	51.8/52.2	/	400	3340/3250	5500/5400	24	4000
518JSX80-4468	1:80	30	/	66/65.5	/	400	2270/2260	8200/8000	24	5000
518JSX80-4468	1:80	50	/	109/107	/	500	5330/5150	16400/16000	24	8000
518JSX181-4468	1:181	30	90	17.4/16.5	/	400	1660/1570	4500/4400	12	3000
518JSX181-4468	1:181	30	110/100	20/19.5	/	400	1920/2050	6700/6400	12	3500
518JSX181-4468	1:181	60	106	30.5	/	550	5000/5000	8200/8200	12	5000
518JSX181-4468	1:181	50	/	18.5/19.2	/	300	1660/1570	3700/3600	24	3500
518JSX181-4468	1:181	70	200	29.3/30	/	400	2650/2540	8200/8000	24	5000
518JSX181-4468	1:181	100	/	45/45.4	/	500	5220/4960	16500/15800	24	8000
518JSX313-4468	1:313	80	210/200	16.5/16.3	/	600	4250/4200	10600/10500	12	5000
518JSX518-4468	1:518	150	/	10.3/10.5	/	600	3050/2920	10500/10200	12	5000
518JSX518-4468	1:518	113	/	3.8/3.7	/	400	560/530	1580/1580	24	1700
518JSX518-4468	1:518	167.7	/	6.5	/	200	1200/1250	3600/3600	24	3400